



Neighbour Hub For Kings Road

HQ NAC
September 19, 2022

What is a Neighbour Hub?



Why are Hubs Important?



Neighbour Hubs in Victoria



Goal to install a Neighbour Hub in every neighbourhood

Standardized design options & maintenance program

2022 – 1 Hub

2023 – 2 Hubs

Neighbour Hubs in Victoria

City-wide engagement Spring 2022

What we heard...

NEIGHBOUR HUBS SHOULD BE:

- Centrally located and accessible by walking cycling or public transit
- Welcoming and inclusive
- Well maintained and activated

NEIGHBOUR HUBS SHOULD INCLUDE:

- Emergency resource storage
- Seating and gathering space
- Signage/community information/maps
- Natural elements / greenery
- Charging stations for devices
- Weather protection

Three Neighbour Hub Templates



HIVE



JEWEL



FERN

Kings Rd Neighbour Hub Timeline

2021	2022			
Nov	June	July-Aug	Sept	Fall/Winter
HQ NAC Placemaking & traffic calming features for Kings Road	Hillside Quadra Engagement Activation Group formed	Community selection of HIVE Design	Community Input on size, location, activation and terms of use	Installation of Neighbour Hub

Kings Rd Neighbour Hub

What we heard

Terms of Use

- All are welcome / safe space
- Operating hours dawn to dusk
- No smoking or vaping
- No dumping / debris
- No amplified music
- Pets welcome

Activation Ideas

- Book nook
- Toy exchange box
- Bike tools/repair station
- Water dish for dogs
- Planter boxes
- Annual painting party

Kings Rd Neighbour Hub

What we heard

Excited About

- Emergency preparedness in “everyday life”
- Accessible design
- Meeting space for neighbours
- High quality materials and construction

Concerns With

- Garbage, debris & maintenance
- Attracting undesirable behaviour
- Loss of on-street parking

Kings Rd Neighbour Hub

September Engagement

Potential Locations

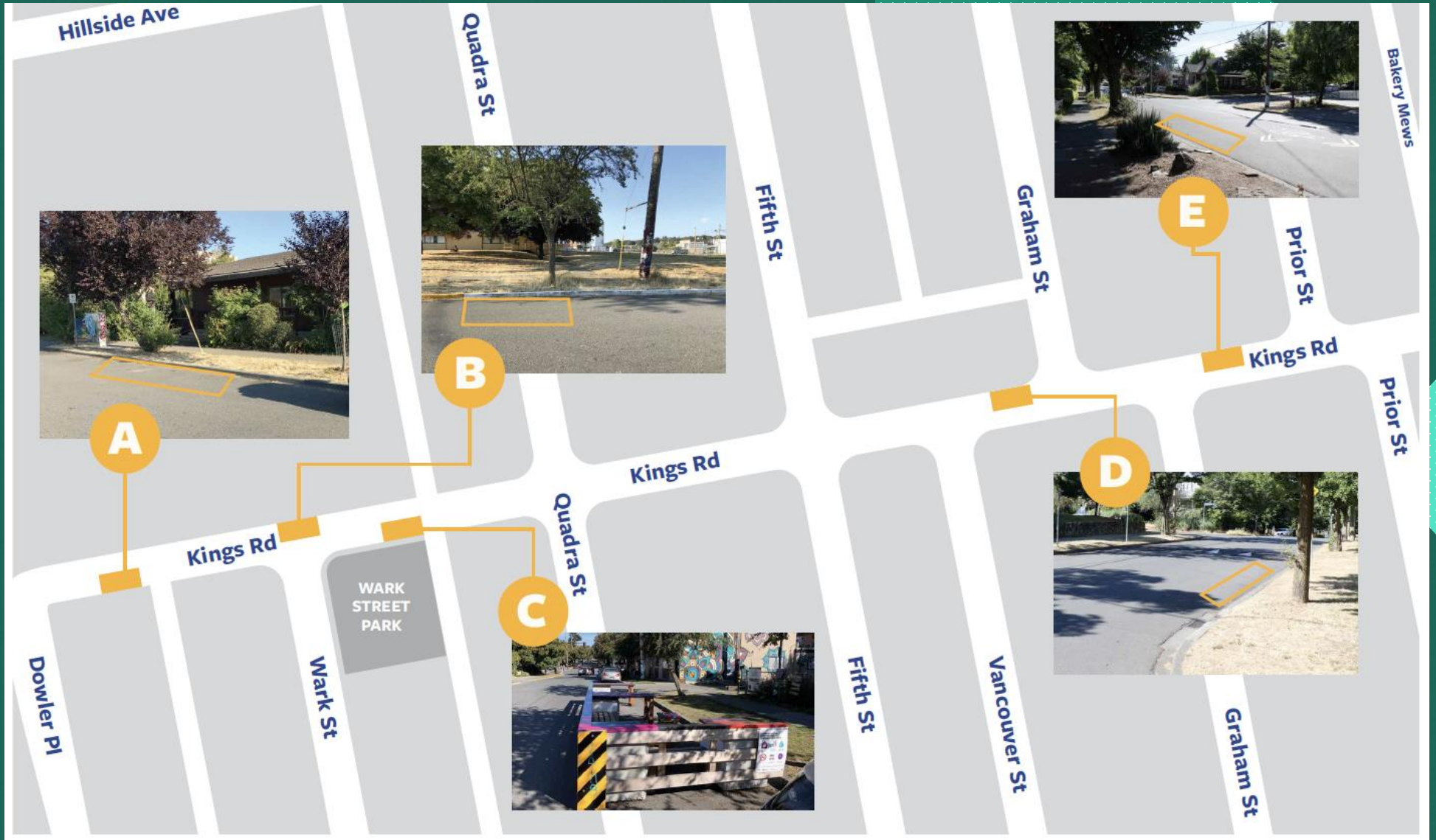

Kings Rd Neighbour Hub September Engagement

1. HIVE Large

Hive large includes emergency storage, varying individual and group seating options, multiple tables and four planters.

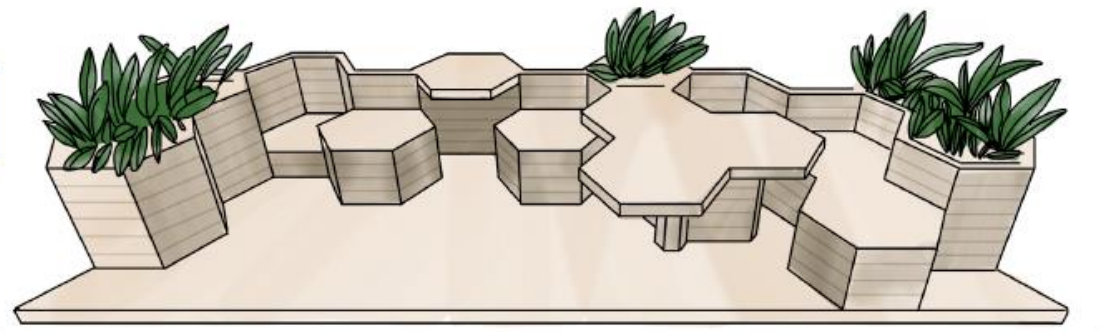

7 m

2. HIVE Medium

The funky HIVE medium design includes emergency storage, comfortable reclined lounge chairs, two planters and varied-sized seating.

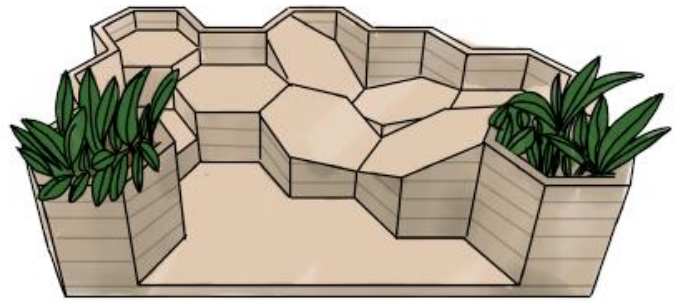

3 m

3. HIVE Small

Small but mighty, the HIVE small incorporates emergency storage, double seating with a table and an individual seat with a planter box.



2 m

Size Options

Kings Rd Neighbour Hub Recommendation

- Large HIVE Hub
- Replace current NAC parklet, set to expire in 2023
- Establish site stewardship & community programming

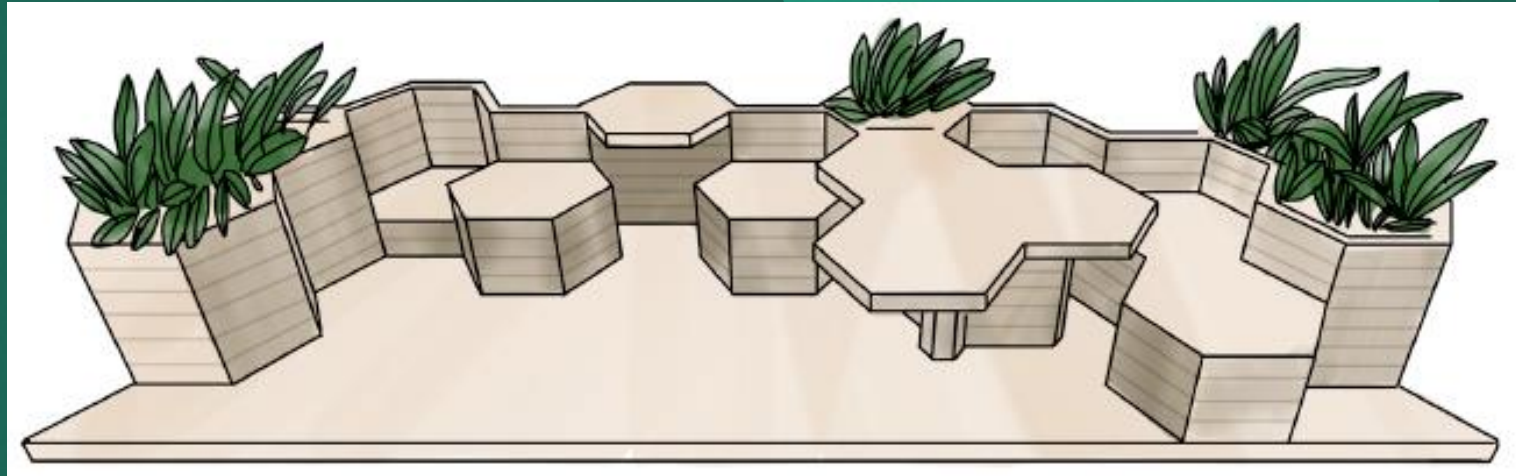

Next Steps

1. Hub Stewardship Grant

- Call of interest to NAC
- Opportunity to align with QVCC programs

2. Inform community of plan

3. Begin installation mid-October

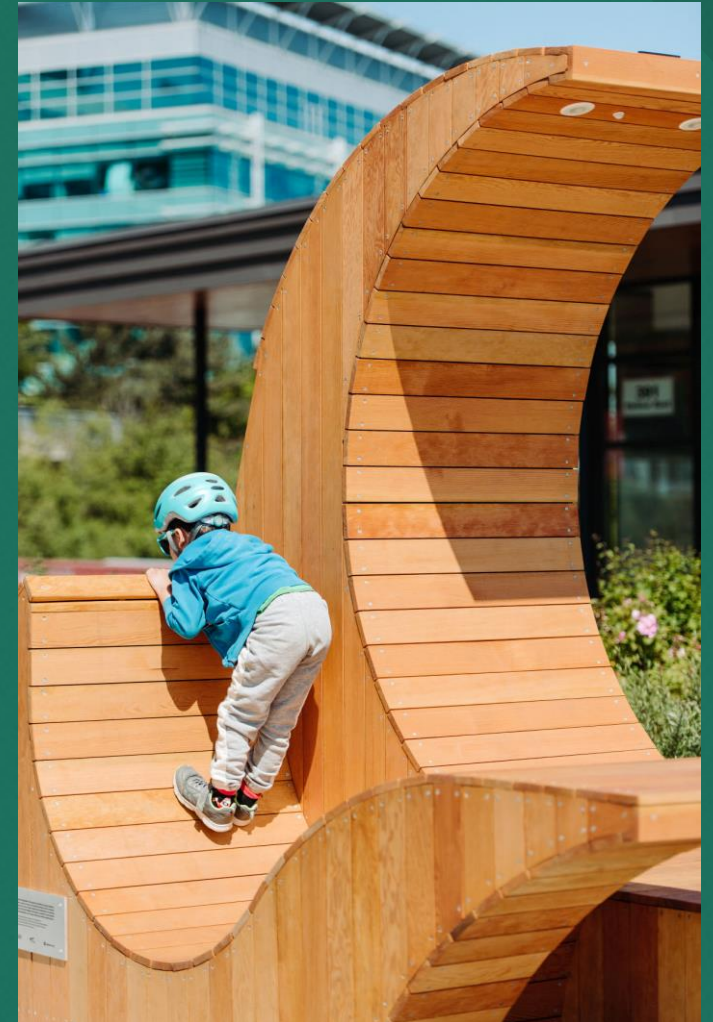

Kings Rd Neighbour Hub

Food for Future Thought

The City heard continued interest in placemaking features east of Quadra Street such as:

- Artistic street or building mural
- On-street planter boxes
- Boulevard fruit tree project
- Drinking / dog water fountain
- Standard benches